

FEATURES

Dual exhaust outlets allow for air distribution to multiple locations

Horizontal solution is great for basement or crawl space application

Engineered for extremely quiet operation

The most energy-efficient large capacity residential dehumidifier on the market

MERV-13 filter provides superior air filtration

Engineered for low temperature operation and the air flow issues that crawl spaces present

Ducting options for divided spaces

Auto restart allows the dehumidifier to automatically restart after a power outage

ACCESSORIES

4021475 MERV-11 Filter (16" x 20" x 2")

4027420 MERV-11 Filters 4-Pack

4027424 MERV-11 Filters 12-Pack

4039391 MERV-13 Filter (16" x 20" x 2")

4037733 MERV-13 Filters 4-Pack

4037734 MERV-13 Filters 12-Pack

4028614 Pump Kit

4028616 Caster Kit

4036685 Hang Kit

4028607 Duct Kit, Supply Only

4028610 Duct Kit, Return Only

4026969 10" Flex Duct 25'

4022126 10" Flex Insulated Duct 25'

4024750 12" Flex Duct 25'

4028366 12" Flex Insulated Duct 25'

4020175 Remote Dehumidistat



PRODUCT SPECIFICATIONS

Part Number	4031470	
Blower	391 CFM @ 0.0" WG	
Power	920 watts @ 80°F and 60% RH	
Supply Voltage	115 volt – 1phase – 60 Hz	
Current Draw	8.0 amps	
Operating Temperature	49°F Min., 95°F Max.	
Crawl Space Sizing		
Very Tightly Sealed	Up to 4,800 Sq. Ft. (24,000 Cu. Ft.)	
Moderately Sealed	Up to 4,000 Sq. Ft. (20,000 Cu. Ft.)	
Some Leaks & Imperfections	Up to 3,600 Sq. Ft. (18,000 Cu. Ft.)	
Basement Sizing		
Very Tightly Sealed	Up to 4,100 Sq. Ft. (41,000 Cu. Ft.)	
Moderately Sealed	Up to 3,800 Sq. Ft. (38,000 Cu. Ft.)	
Some Leaks & Imperfections	Up to 3,600 Sq. Ft. (36,000 Cu. Ft.)	
Minimum Performance at	80°F and 60%RH	70°F and 60%RH
Water Removal	155 Pints/Day	123 Pints/Day
Efficiency	7.3 Pints/kWh	7.2 Pints/kWh
Energy Factor	3.4 L/kWh	3.4 L/kWh
Air Filter Size	MERV-13, Standard Pleat 16" x 20" x 2"	
Power Cord	9', 115 VAC, Ground	
Drain Connection	3/4" Threaded Female NPT	
Drain Hose	8' Direct Gravity Drain Hose (5/8" ID x 7/8" OD)	
Refrigerant	R410A, 2 lbs., 1 oz.	
Unit Dimensions	20.25"W x 21.75"H x 38"D	
Shipping Dimensions	25"W x 28"H x 42"D	
Unit Weight	140 lbs.	
Shipping Weight	159 lbs.	

INSTALLATIONS

Supply Duct Kit

Place the Santa Fe Impact155 in the unfinished area of the basement, near a drain access (condensate will drain via gravity or with an optional pump kit).

Using the supply duct collar, supply the dry air from the dehumidifier into a large, open area in the finished section of the basement.

Place a return grill / passive vent on the other side of the wall that separates the finished and unfinished areas. This will allow for a circular air flow throughout the basement.

The passive grill will prevent the unfinished room from being placed under a negative pressure and also allow the dehumidifier to focus on keeping the unfinished area dry as well.

The onboard dehumidistat control can be used on the unit for this application or a 120 volt dehumidistat can be placed in the finished basement as well (we recommend using an electrician to run the wiring).

Be sure to keep all doors open to any other rooms in the basement to help with proper air circulation (bedrooms, bathrooms, etc.).

Supply and Return Duct Kit

Place the Santa Fe Impact155 in the unfinished area of the basement, near a drain access (condensate will drain via gravity or with an optional pump kit).

Using the supply and return duct kit, supply the dry air from the dehumidifier into a large, open area of the finished basement. Use the return duct kit to draw air back through the dehumidifier.

Be sure the return and supply are at least 10 feet away from each other for proper air flow throughout the basement. Add a passive grill between the finished and unfinished areas (*or have a 2" gap under the door separating the two rooms). This will help keep the unfinished area dry as well.

Use the 120 volt, wall mounted dehumidistat for this installation for proper run time on the dehumidifier (we recommend using an electrician to install the separate 120 volt control).

Be sure to keep all doors open to any other rooms in the basement to help with proper air circulation (bedrooms, bathrooms, etc.).

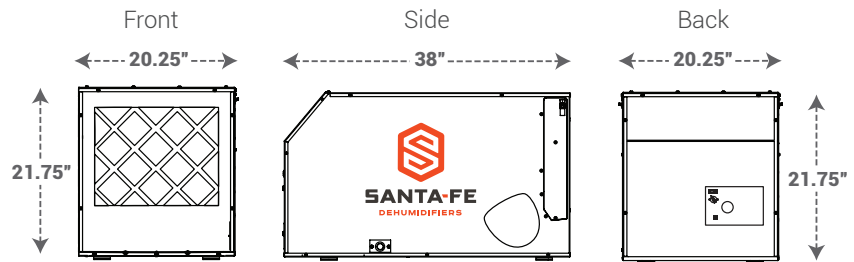

Supply Duct Kit

- ① Passive Return Vent
- ② Optional Wall Mount Dehumidistat
- ③ Supply Grill
- ④ Supply / Discharge Duct Work

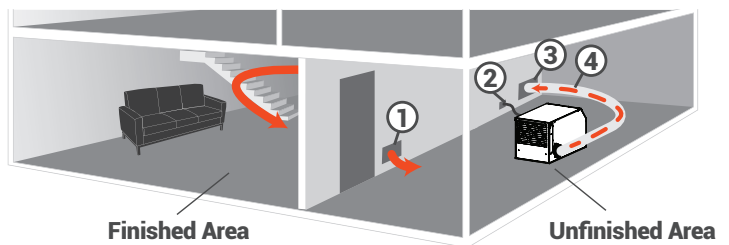

Supply and Return Duct Kit

- ① Return Grill
- ② Passive Return Vent*
- ③ Optional Wall Mount Dehumidistat
- ④ Supply Grill
- ⑤ Supply / Discharge Duct Work
- ⑥ Return / Intake Duct Work

